



## Product categories



Frozen Food  
and Ice cream

## Technical features



Ventilated

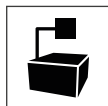

Remote  
condensing unit



LED lighting



High efficiency  
fans



Electric defrost



## Certification and patents



Eurovent\*

\* Epta S.p.A. participates in the ECC programme for:  
Refrigerated display cabinets (RDC); Check ongoing validity  
of certificate online: [www.eurovent-certification.com](http://www.eurovent-certification.com)  
or using: [www.certiflash.com](http://www.certiflash.com)

## Product range

CAYMAN UP					
<b>Lenght-Lunghezza</b> Longueur-Länge-Longitud mm		<b>1880</b>	<b>2500</b>	<b>3750</b>	<b>EOL2240</b>
<b>CAYMAN UP</b>	<b>H2000</b>	•	•	•	•
	<b>H2200</b>	•	•	•	•
<b>Dispaly area</b> Superficie di esposizione Warenpräsen- tationsfläche Surface d'exposition Superficie expositiva m2	<b>H2000</b>	1.83	2.45	3.68	1.83
	<b>H2200</b>	2.06	2.76	4.15	2.06
<b>Loading area</b> Superficie di appoggio Nutzfläche Surface de chargement Superficie de apoyo m2	<b>H2000</b>	2.22	2.94	4.41	2.22
	<b>H2200</b>	2.22	2.94	4.41	2.22
<b>Net storage capacity</b> Capacità netta Nutzinhalt volume utile Capacitat neta dm3	<b>H2000</b>	1193.00	1581.00	2372.00	1193.00
	<b>H2200</b>	1344.00	1781.00	2672.00	1344.00
<b>End thickness</b> Spessore spalla Stärke der Seitenwand Épaisseur de cheue joue Espesor lateral mm		51.00 (+ 104 Batticarrello/Bumper Rail/Pare-choc Wagenstoßleiste/Parachoques)			

## Cross sections

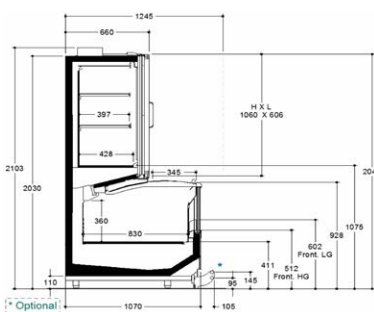

20 LINEAR

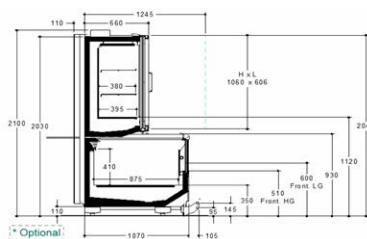

EOL - 20

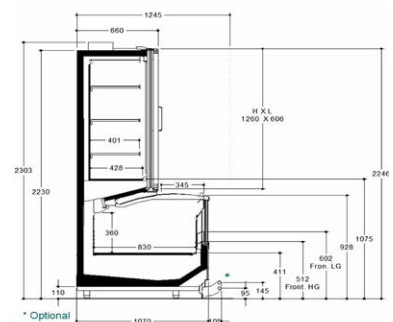

22 LINEAR

## Cross Sections

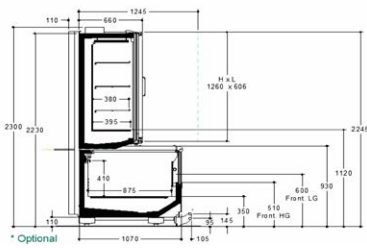

EOL - 22

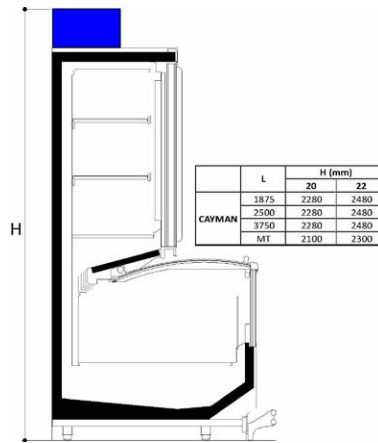

EPTABLUE - OPTION