

# PRESENTATION

GRANBERING INTEGRAL R-290

# GRANBERING INTEGRAL R-290

COSTAN



2



**New :  
up to 4 doors!**

**All benefits of a remote vertical freezer  
in a plug and play solution**

# GRANBERING INTEGRAL R-290

COSTAN❄️



3

## What is Integral technology?

Integrale technology is an all in one plug and play solution matching GranFit premium aesthetics, perfect product visibility, enhanced loading and first in class performance together with Epta undisputed technical leadership in self contained unit engineering and manufacturing skills.

Our new product is offering you the opportunity to replace expansive and high maintenance cost power pack dedicated to freezer area by a plug and play full integrated solution. Especially designed for convenience and small store surface, Integral technology is a market unique and Epta exclusive product already tested and approved by our most demanding customers all over Europe.

Integral technology offers you new perspective and approach of refrigeration system design, facilitating installation phase, making start up faster and decreasing maintenance cost.

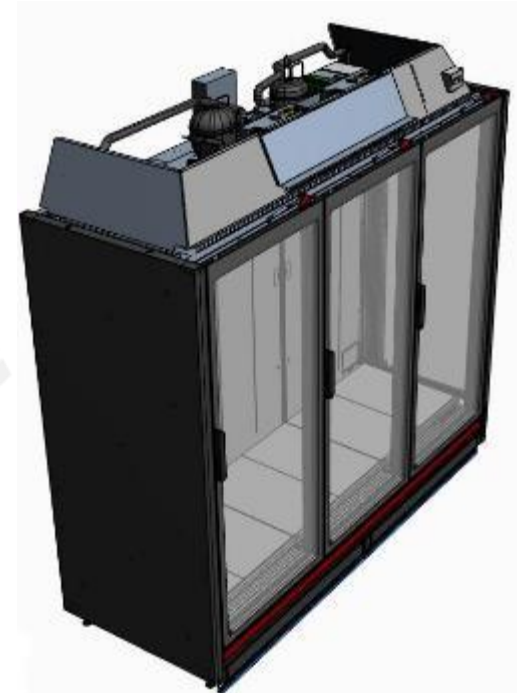

# GRANBERING INTEGRAL R-290

COSTAN❄️

Epta

How does it work

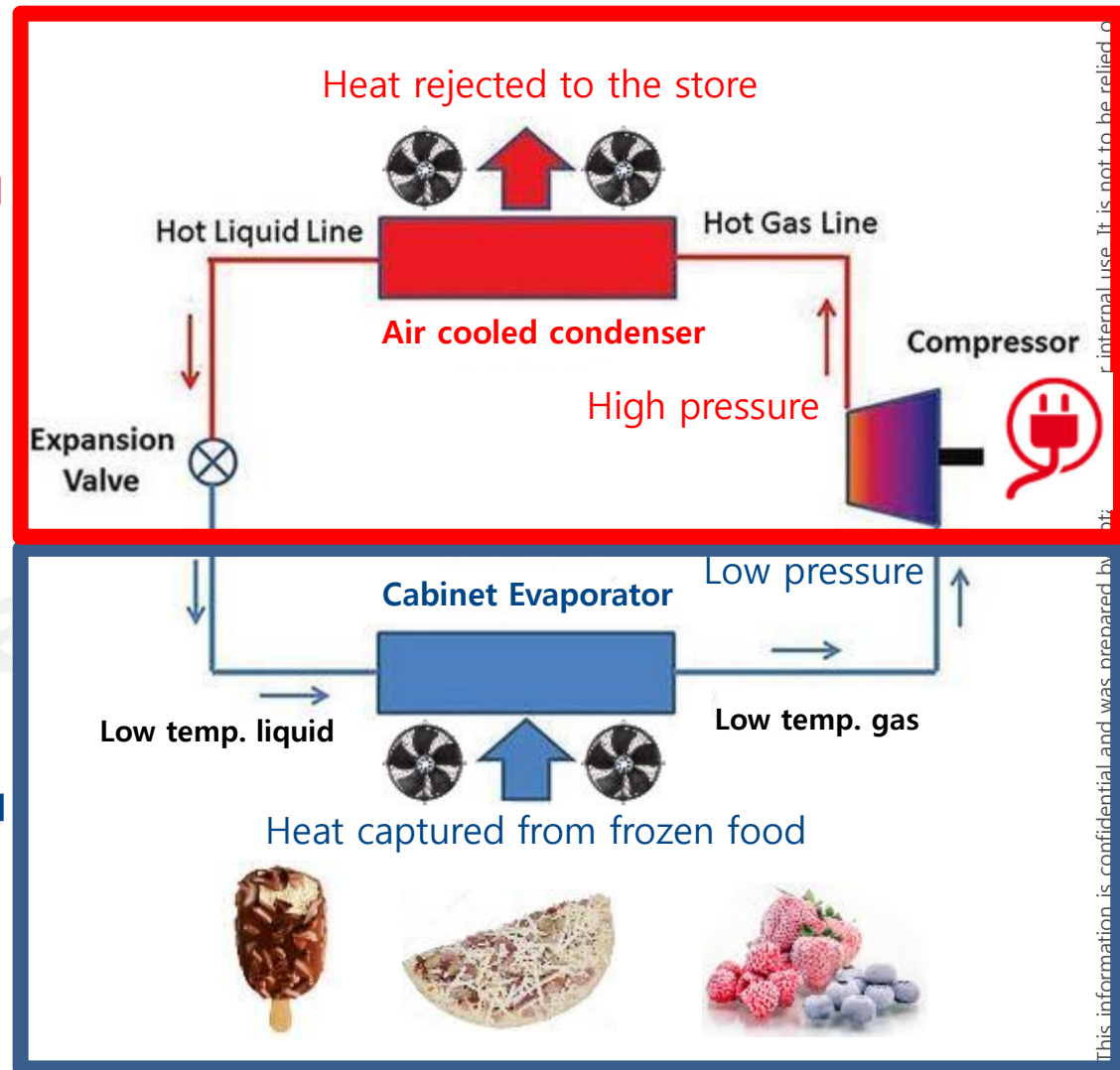
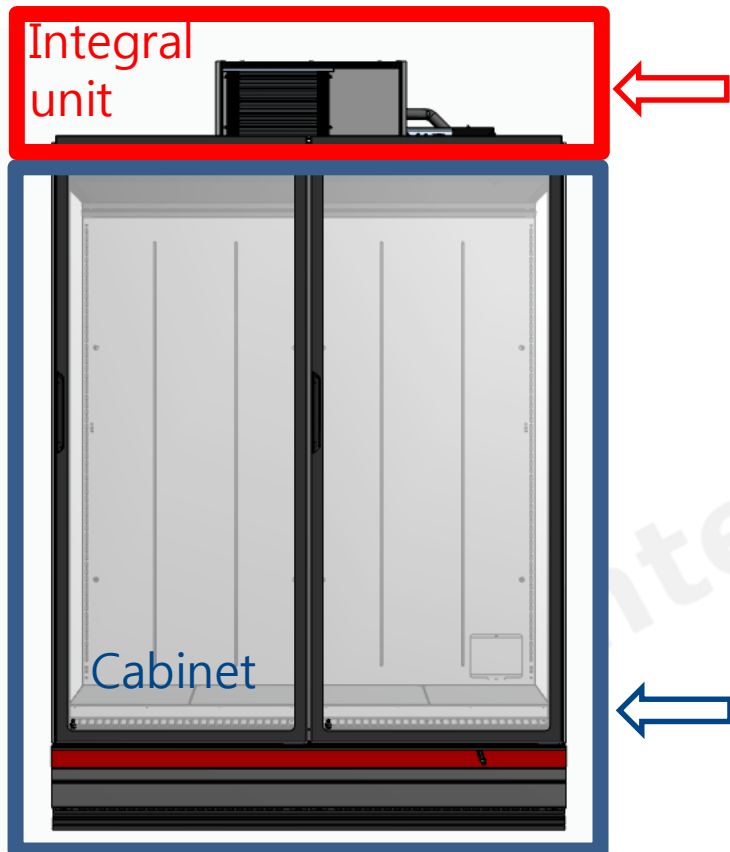

# GRANBERING INTEGRAL R-290

COSTAN



5

## Main advantages

### Integral technology main advantages are :

- **High efficiency self-contained unit** with new generation **inverter compressor** (on 3, 3S and 4 doors model only)
- **2 doors, 3 doors and 3S are single phase** plug and play electrical connection
- **R290A** refrigeration circuit F-Gas complaint and environmental friendly solution
- Large offer of **communicating controllers** compatible with ModBus building management system for an easy integration
- **All features and options of a remote** vertical freezer in a self-contain unit one
- **Every single cabinet is independent** and can be switched off during maintenance operation without negative impact on rest of the linear productivity.

# GRANBERING INTEGRAL R-290

COSTAN❄️



6

## Product at a glance

### GranBering Integral product range

HEIGHT	H20		COMPRESSORS PER CABINETS
DEPTH	COMPACT	NARROW	
2D	X	X	1
2D EOL	N/A	TM	1
3D	X	X	2
3D EOL	N/A	X	2
3D-S EOL	N/A	X	2
4D	X	X	2
5D	N/A	N/A	N/A

H22 version is not available



### Main features :

- Flexibility and merchandising of a remote
- High modularity thanks to GranBering multiplexable design
- New dedicated 3 doors S shorter end of line able to fit with small aisles constrains
- Plug and play design of a self contained unit
- Narrow and Compact depth as standard

- Eco friendly natural refrigerant R290
- DC inverter compressor
- Dual circuit evaporator
- High efficiency air cooled condenser
- Smart communicating control
- Easy to install devices



# GRANBERING INTEGRAL R-290

COSTAN ❄️

Epta

## Store pictures



Multiplexed linears → unique on self contained unit market

Marketing 02/2020

# GRANBERING INTEGRAL R-290

COSTAN

Store pictures

Epta

8



Complete frozen area together with Beluga



# GRANBERING INTEGRAL R-290

COSTAN

Epta

Store pictures



Smart integration with store aesthetics and communication devices

# GRANBERING INTEGRAL R-290

COSTAN❄️

Epta

10

## Store pictures



Back to back linears + End of line ➔ unique on self contained unit market



# GRANBERING INTEGRAL R-290

COSTAN

Epta

11

## Store pictures



3D-S end of line for narrower island makes bigger aisles for shoppers

# GRANBERING INTEGRAL R-290

COSTAN❄️

Epta

12

Store pictures



Marketing 02/2020

Compact version optimized for convenience stores or small shops

This information is confidential and was prepared by Epta solely for our internal use. It is not to be relied on by any third party without Epta prior written consent



# GRANBERING INTEGRAL R-290

COSTAN

Epta

13

## Dimensions – H20 Compact

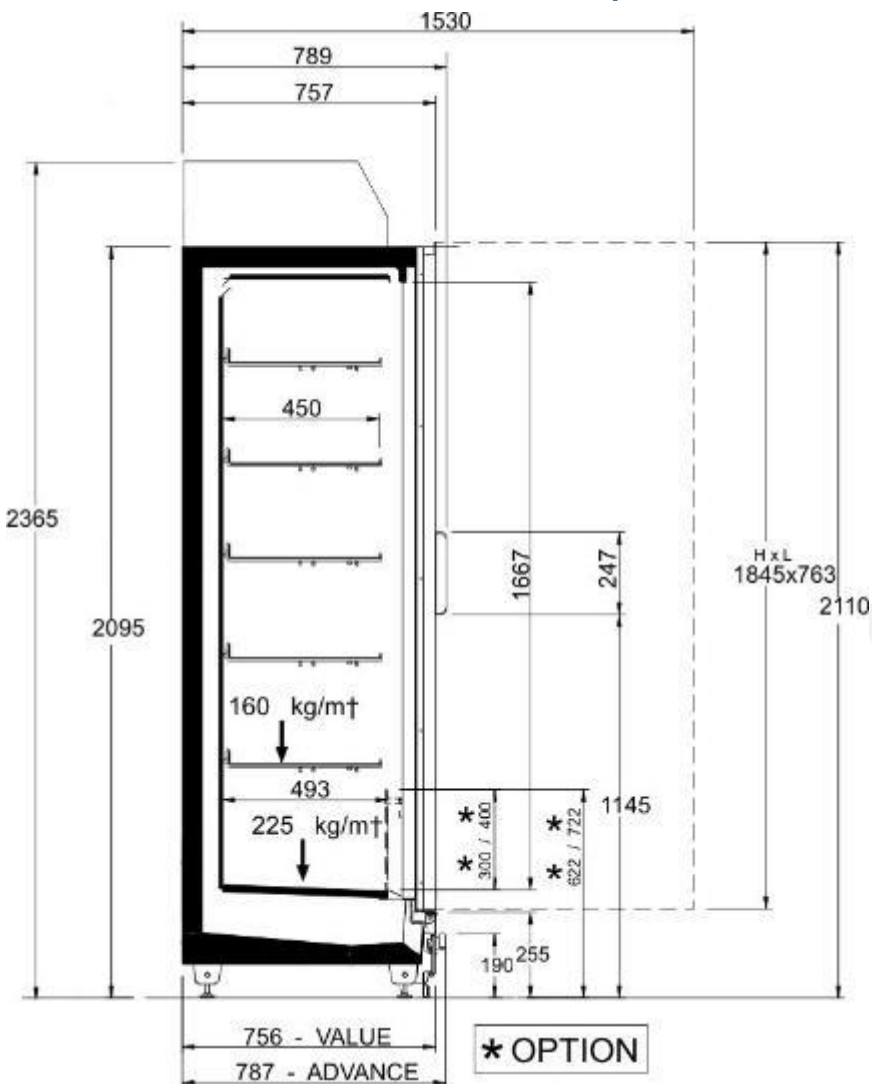

Models	L (mm)	L (mm)	O (m <sup>2</sup> )	kg	V (dm <sup>3</sup> )	TDA (m <sup>2</sup> )
		Glass	Blind	Max	450	450
2P	1562	1664	1664	2,3	-	1218,4
3P	2343	2445	2445	3,5	-	1827,5
4P	3124	3226	3226	4,6	-	2436,7

# GRANBERING INTEGRAL R-290

COSTAN

Epta

14

## Dimensions – H20 Narrow

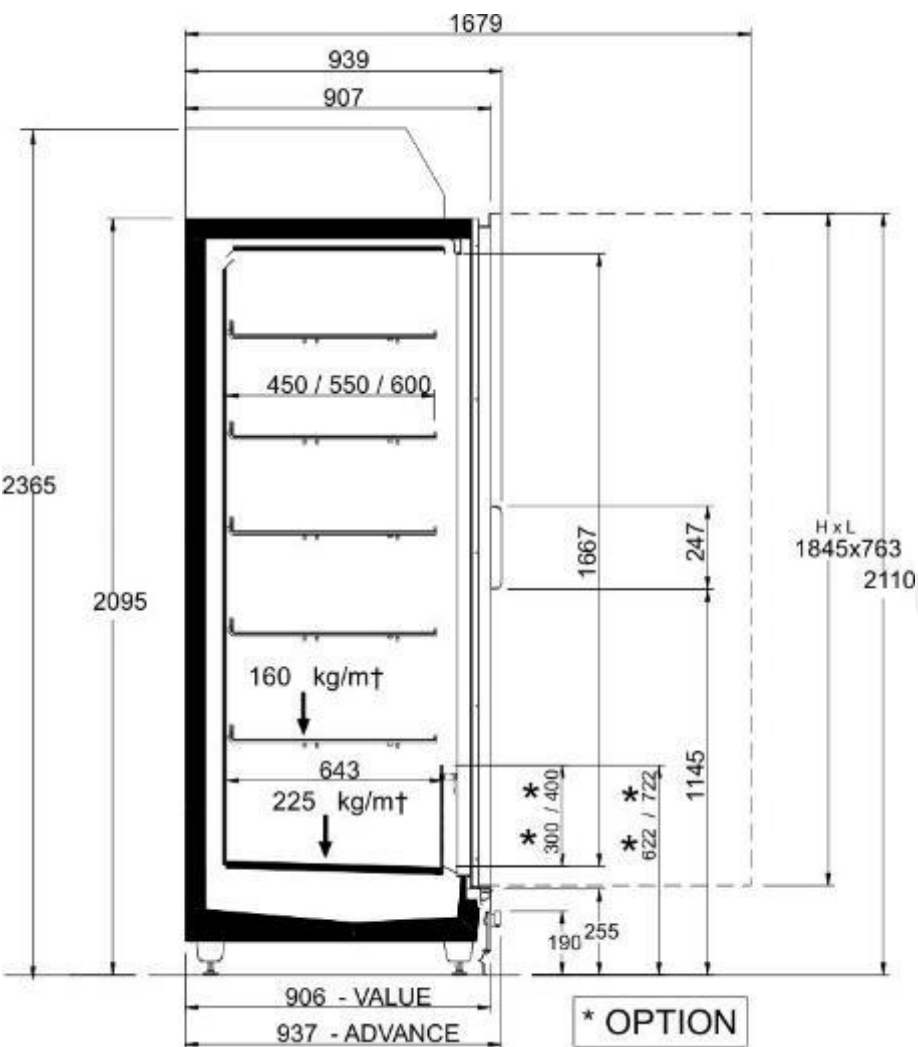

Models	L (mm)	L (mm)		O (m <sup>2</sup> )	kg Max	V (dm <sup>3</sup> )			TDA (m <sup>2</sup> )		
		Glass	Blind			450	550	600	450	550	600
2P	1562	1664	1664	2,3	-	1265,2	1562,0	1608,9	2,5	2,4	2,3
3P-S	1923	2025	2025	2,8	-	1557,6	1923,0	1980,7	3,0	2,8	2,8
3P	2343	2445	2445	3,5	-	1897,8	2343,0	2413,3	3,8	3,6	3,5
4P	3124	3226	3226	4,6	-	2530,4	3124,0	3217,7	5,0	4,8	4,6

# GRANBERING INTEGRAL R-290

COSTAN

Energy consumption – Climate Class 3



15

## GRANBERING INTEGRAL H2O NARROW

Performance	Lenght	2D	3D	3D S	4D
Store climatic conditions	°C/HR	25°C/60%	25°C/60%	25°C/60%	25°C/60%
Supply voltage	V/ph/Hz	230/1/50	230/1/50	230/1/50	400/3/50
T.E.C.	kWh/day	23,0	31,5	30,6	44,6
T.D.A.	m <sup>2</sup>	2,5	3,8	3,0	5,0
T.E.C. / T.D.A.	kWh/day/m <sup>2</sup>	9,2	8,3	10,2	8,9
Volume	m <sup>3</sup>	1,6	2,4	2,0	3,2
TEC / Volume	kWh/day/m <sup>2</sup>	14,4	13,1	15,3	13,9
Rejected heat to the ambience	W	960	1315	1275	1860
Classification	----	3L1	3L1	3L1	3L1



Epta S.p.A. participates in the ECC programme for:  
Refrigerated display cabinets (RDC). Check ongoing validity  
of certificate online: [www.eurovent-certification.com](http://www.eurovent-certification.com)  
or using: [www.certifiedh.com](http://www.certifiedh.com)

